

# Specification Sheet for FC500 / 750 Range

Company Name: \_\_\_\_\_ Date: \_\_\_\_\_

Order Number: \_\_\_\_\_ Quantity required: \_\_\_\_\_

☐ Deliver Lift ☐ Collect Lift from Del Delivery Date Required: \_\_\_\_\_

## Do you have a forklift to unload?

☐ Yes ☐ No, require DEL to provide a Fork Lift

## Delivery Address

Company Name: \_\_\_\_\_ Street Address: \_\_\_\_\_

Post Code: \_\_\_\_\_ City: \_\_\_\_\_

## Vehicle Details

☐ Rigid

### Vehicle Type:

☐ Box Van ☐ Curtainsider

Vehicle Make & Model: \_\_\_\_\_

Chassis Mass: \_\_\_\_\_

**For Dimensions Information, see Sheet 4.**

Dimension A (Floor Height): \_\_\_\_\_ mm (Max 1060mm)

**\*\*For Low Floor Vehicles the minimum Floor Height requirement is 600mm Laden.**

### Vehicle Voltage:

☐ 12v ☐ 24v

**Please select Dimension L (Distance from the vehicle floor to the top of the lift roof) size below:**

☐ 2160mm ☐ 2220mm ☐ 2240mm ☐ 2275mm ☐ 2300mm ☐ 2320mm

☐ 2345mm ☐ 2400mm ☐ 2475mm ☐ 2515mm ☐ 2545mm ☐ 2605mm

**Please select W (Width over Panels) size below:**

☐ 2065mm ☐ 2075mm ☐ 2085mm ☐ 2090mm

☐ 2135mm ☐ 2190mm ☐ 2235mm ☐ 2280mm

## Tail Lift Details

### Lift Capacity:

☐ 500kg ☐ 750kg

### Platform Working Area:

☐ 1065mm ☐ 1168mm ☐ 1370mm

### Rear Ramp Type:

☐ 205mm Fixed Leading Edge (Trolley Stops standard)

### External Control:

☐ Slimline pre-wired Control ☐ Fixed Control ☐ Detachable Wanderlead

### Internal Control:

☐ Fixed Control ☐ Hard wired Wanderlead ☐ None **(Only applicable with Detachable Wanderlead)**

### Internal Control Bracket: **(If second Control required)**

☐ Bracket with Deflector Plate ☐ Bracket with No Deflector Plate

### Tail Lift Isolator: **(Not required if you have Single Detachable Wanderlead).**

☐ Cab Switch ☐ Red Key Isolator ☐ VDHH

### Cable Options:

☐ 22' Battery Cables (Standard) ☐ 35' Battery Cables ☐ Plug & Play Kit **(Please see page 3 for details)**

### Fence Type: **(Auto Erect Fences not suitable for FC750)**

☐ N/S Drop Down Fence & O/S Auto Erect Fence ☐ O/S Drop Down Fence N/S Auto Erect Fence ☐ Pair of Drop Down Fences  
☐ Pair of Auto Erect Fences ☐ Pair of Drop in Fences ☐ Sockets only for Drop in Fences

### Options:

☐ Low Floor Application (Bed Heights lower than 800mm) ☐ Battery Guard ☐ Left Hand Drive

### Warranty Options: **(12 Month Warranty as standard)**

☐ 2 Year Warranty ☐ 3 Year Warranty ☐ 4 Year Warranty ☐ 5 Year Warranty

**Plug & Play Kit Options: (Only available on FC500)**

☐ Option 1 – Plug & Play on Power, Earth & 2-Core Only.

**Cables attached to the Tail Lift Power Pack/ Beam:**

1800mm CABLE FOR CAB SWITCH WITH PLUG

2000mm BATTERY CABLES WITH PLUG

**Kit Box sent in advance includes:**

21' POWER CABLE (WIRED TO ANDERSON PLUG)

WIRED TO 200A MEGA FUSE

21' EARTH CABLE (WIRED TO ANDERSON PLUG)

30' 2 CORE FOR CAB SWITCH WITH CONNECTOR

CAB SWITCH KIT

☐ Plug & Play Kit to be supplied with the Lift    ☐ Plug & Play Kit sent in advance (**large volume orders only**).

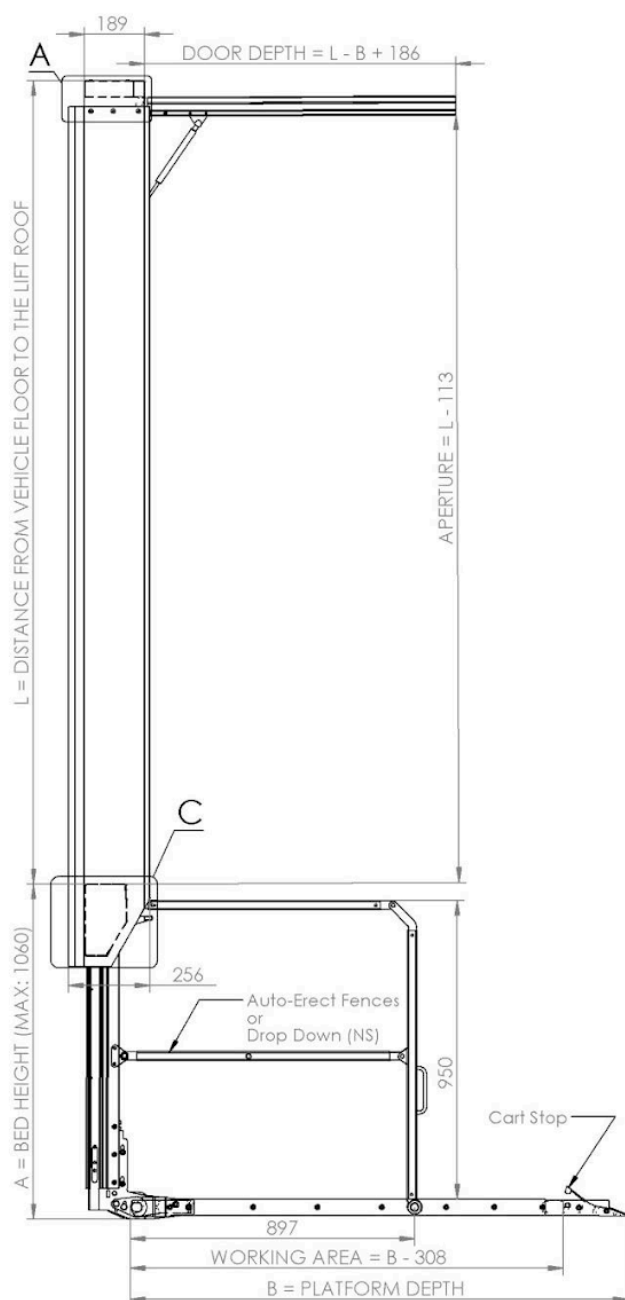

DETAIL A

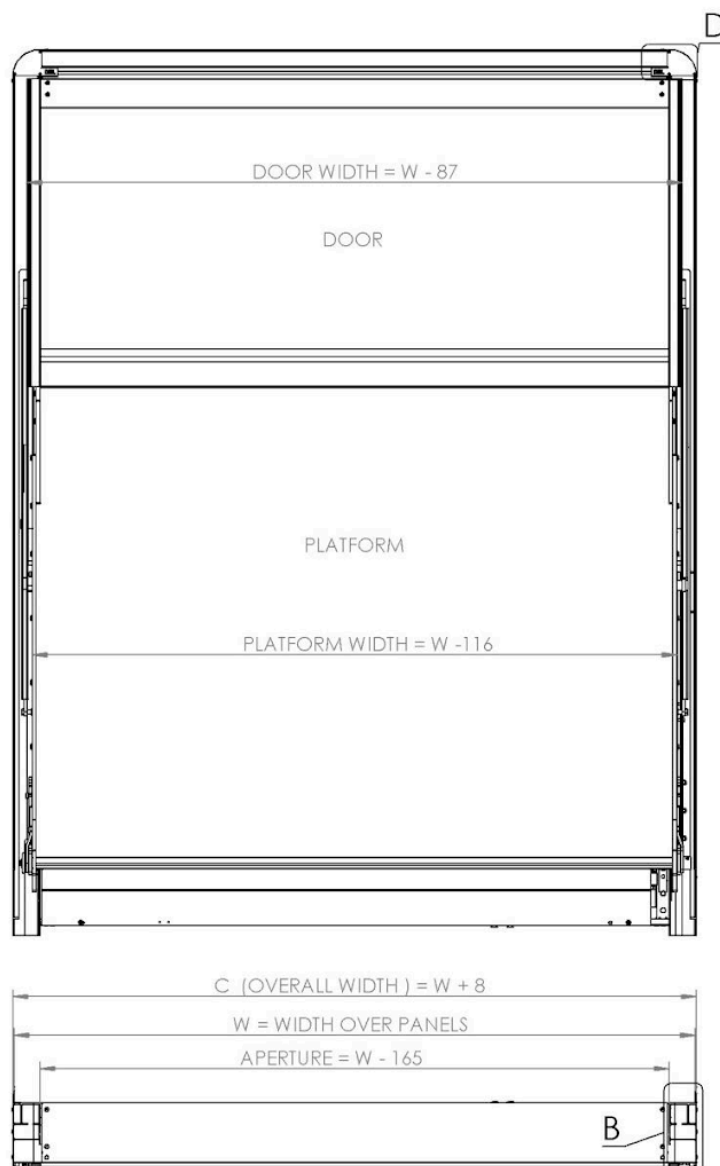

DETAIL C

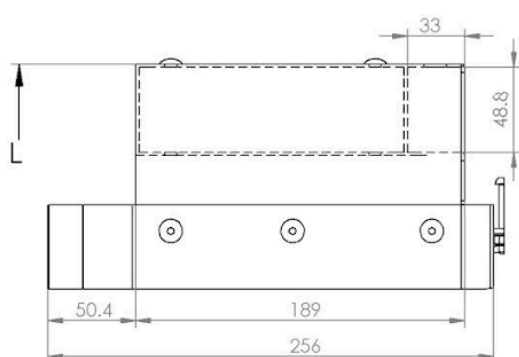

DETAIL B

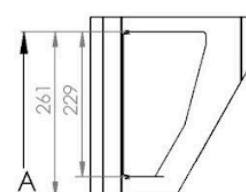
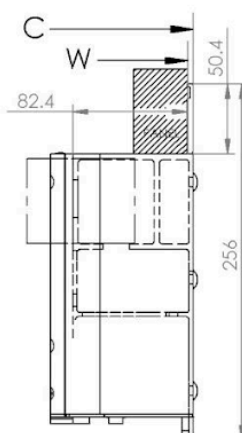

DETAIL D

